

THE SUMMERTIME
 2 Bedroom | 2 Bath
 1,016 Sq. Ft.

from \$ _____ /mo.

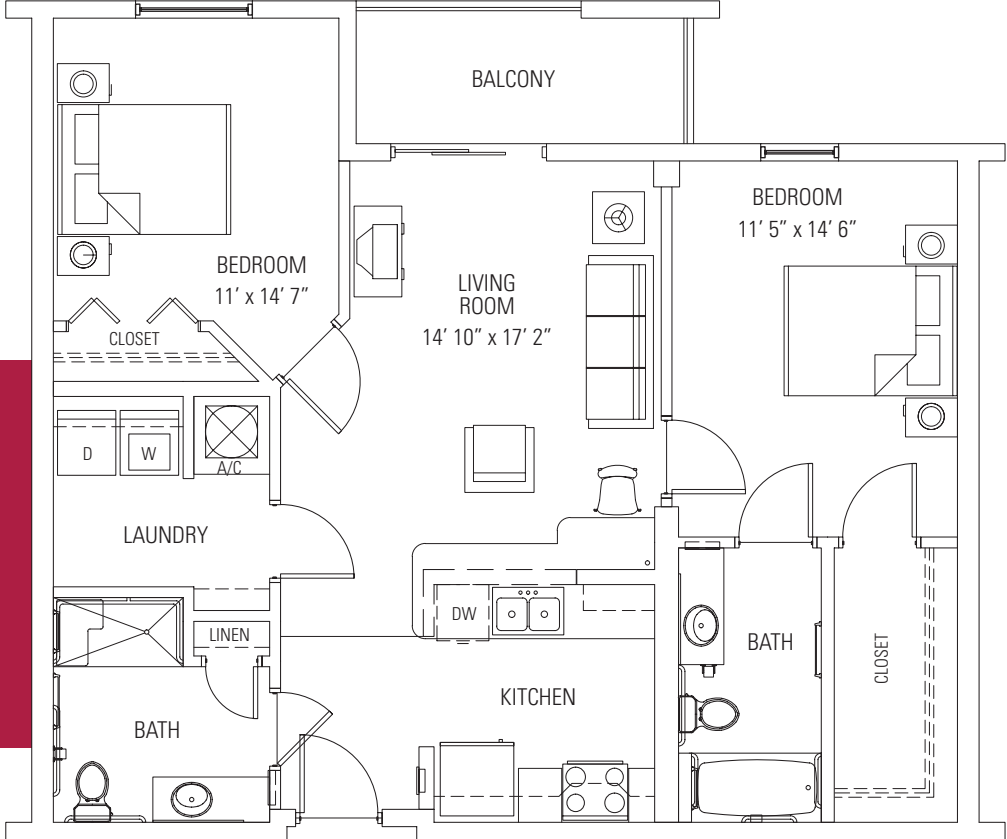

INSPIRING INTERIORS

- Designer-inspired one and two-bedroom plans
 - Contemporary kitchens with black refrigerator, stove, and dishwasher
 - Generous double sink with disposal
 - Decorative glass pendant lights over kitchen bar
 - Ceiling fans in living room and bedrooms
 - Walk-in closets*
 - Comfort-height bathroom vanities
 - Additional accessibility features*
 - Spacious laundry room with connections for full-size washer and dryer
 - Convenient built-in computer desk
 - Cable-ready
 - Balcony with spectacular downtown Tampa skyline views*
 - Oversized patios*
- *select apartment homes

